



ASPECTA™

TEN

Featuring  **ISO CORE** Technology™



PROFESSIONAL INSTALLATION GUIDE

100% WATERPROOF
COMMERCIAL FLOATING LUXURY VINYL FLOOR

Revised 03/01/2019

This document supersedes all printed and electronic Installation and Technical Guides previously distributed for Aspecta TEN.



GET TO KNOW ASPECTA™ TEN

FEATURING ISOCORE TECHNOLOGY™

- Aspecta TEN is intended for interior commercial use only and is suitable for above-grade, on-grade and below-grade applications. However, Aspecta TEN should not be installed in locations where the substrate beneath the building structure is exposed to the elements.
- Aspecta TEN is to be installed as a floating floor system and must be free to move as a whole sheet in response to changes in temperature. It must not be glued, nailed, or fastened to the substrate, walls or fixed to any part of the building structure. Install permanent fixtures such as walls, partitions, shelving, cabinets, displays, counters, tracks for transition profiles and similar items first, then fit Aspecta TEN around them, leaving a space for expansion and contraction. Fill expansion spaces around potentially wet areas with premium waterproof 100% silicone caulk. Always remove standing water, pet urine and other liquids promptly.
- Direct sunlight may cause Aspecta TEN to fade or to expand, causing the floor to buckle or separate. Protect Aspecta TEN from direct sunlight using window treatments or UV tinting on windows. Aspecta TEN is not recommended for use in sunrooms.
- Aspecta TEN is a waterproof floating floor, but it should not be used to seal an existing floor from moisture. Aspecta TEN cannot inhibit the growth of mold or prevent structural problems associated with, or caused by flooding, excessive moisture, alkalis in the subfloor, or conditions arising from hydrostatic pressure. Regardless of location, always remove standing water, urine and other liquids promptly. *Jobsite moisture issues must be addressed and corrected prior to installation.*





ASPECTA
TEN
Featuring  **ISO CORE** Technology™

PRE-INSTALLATION ESSENTIALS

Your job will be smooth, fast and easy when you follow the essentials every time you install Aspecta TEN.

EVALUATE THE JOB SITE

EXTERIOR

Damage caused by water and high humidity should be addressed prior to installing Aspecta TEN.

- Examine the driveway, parking areas and landscaping surrounding the building. Be sure that they slope and direct water away from the foundation.
- Inspect gutters, down spouts and drains for blockage. Remove clogs caused by leaves, dirt and debris, allowing runoff to flow freely away from the foundation.
- Check crawl spaces for cross-ventilation air vents equaling at least 1.5% per 100 square feet (9.3 square meters) of floor space. Crawl spaces should measure a minimum of 18 inches (46.0 cm) high and should be insulated according to the latest building code requirements. The ground should be covered with a minimum 6-mil vapor barrier.

INTERIOR

Jobsite moisture issues must be addressed and corrected prior to installation.

- Examine the installation site for leaky plumbing, including leaks from water heaters, wet bars, soda fountains, or any other water-bearing fixtures or pipes.
- Inspect substrates for levelness. They must be sturdy, sound, and flat within $\frac{3}{16}$ of an inch (5.0mm) within a 10-foot (3.0 meters) radius without any abrupt height differences. The substrate should not slope more than 1 inch (25.0mm) per 6 feet (1.8 meters) in any direction
- Aspecta requires testing of concrete substrates for relative humidity, moisture and pH before installing Aspecta TEN. Test results should not exceed 85% relative humidity (RH). The Calcium Chloride Test for moisture should be no more than 8 lbs per one-thousand square feet in 24 hours MVER (Moisture Vapor Emission Rating), and pH tests for alkalinity levels should register between 7 and 9.
- Aspecta requires testing of wood substrates for moisture. Obvious signs of moisture issues include warping, peaking, degradation of the integrity of the substrate, rusted fasteners, and rusted floor registers. Even if obvious signs are not present, the material should be tested using a professional moisture meter; moisture levels should not exceed 14%.

ATTENTION: Mold and mildew grow only in the presence of moisture. Jobsite moisture issues must be addressed and corrected prior to installation. Please visit www.epa.gov/mold for information about safely preventing and removing mold, mildew and other biological pollutants.

IDENTIFY YOUR SUBSTRATE

APPROVED SUBSTRATES

Aspecta TEN is suitable for use over a wide variety of substrates.

CONCRETE

Aspecta TEN is waterproof, but jobsite moisture issues must be corrected before installation begins to prevent serious damage to the subfloor and surrounding structure, and to discourage the growth of mold and mildew. Concrete substrates should be prepared in accordance to the most current version of ASTM F710 (Standard Practice for Preparing Concrete Floors to Receive Resilient Flooring). Concrete substrates must be sturdy, sound, and flat within $\frac{3}{16}$ of an inch (5.0mm) within a 10-foot (3.0 meter) radius without any abrupt height differences. The substrate should not slope more than 1 inch (25.0mm) per 6 feet (1.8 meters) in any direction. Moisture and alkalinity tests should be performed on all concrete substrates regardless of grade level or age of slab. Perform either ASTM F2170 In-Situ Relative Humidity (RH) test or ASTM F1869 Calcium Chloride Moisture Test (MVER: Moisture Vapor Emission Rating). Perform pH test per ASTM F710 to determine alkalinity of the slab. RH Test results should not exceed 85% relative humidity. The Calcium Chloride Test for moisture should measure no more than 8lbs per one-thousand square feet in 24 hours MVER, and pH tests for alkalinity levels should register between 7 and 9. Electronic meter testing is not considered a replacement for a Calcium Chloride Test or Relative Humidity Test. All moisture tests should be conducted prior to installation to ensure that moisture is at recommended levels. Follow current ASTM F710 guidelines. Aspecta highly recommends that substrate moisture and pH testing are conducted by an ICRI (International Concrete Repair Institute) tier 2 certified technician.

RADIANT HEAT

Radiant heating systems must be cast $\frac{1}{2}$ -inch (12.7mm) below the surface of the concrete slab, and should be operating at least 2 weeks before installing Aspecta TEN. Set the temperature of the radiant heating system to 68°F (20°C) 48 hours before, during, and 72 hours after installation. The temperature of the radiant heat floor may be increased gradually 72 hours after installation, but the surface temperature should never exceed 85°F (29°C). Contact the manufacturer of your radiant heating system for further recommendations.

PLYWOOD, OSB, PARTICLEBOARD & CHIPBOARD

Wood substrates must be A.P.A. approved with a minimum grade of "BB" or "CC". They must be sturdy, sound, and flat within $\frac{3}{16}$ of an inch (5.0mm) within a 10-foot (3.0 meters) radius without any abrupt height differences. The substrate should not slope more than 1 inch (25.0mm) per 6 feet (1.8 meters) in any direction. Aspecta recommends performing moisture tests prior to installation to prevent serious damage to the subfloor and surrounding structure, and to discourage the growth of mold and mildew. Moisture readings should never exceed 14% for plywood, OSB, particleboard and chipboard substrates. If moisture readings exceed 14%, it is advisable to correct moisture issues at the jobsite before installing Aspecta TEN.



ASPECTA TEN

Featuring  ISO CORE Technology™

TILE, TERRAZZO, ASBESTOS TILE, RESILIENT TILE, NON-CUSHION SHEET VINYL, AND METAL

Existing floors must be firmly attached to the structural floor. In order to prevent vertical deflection (movement) and potential damage to the integrity of the Aspecta TEN flooring, all substrates must be sturdy, sound, and flat within $\frac{3}{16}$ of an inch (5.0mm) within a 10-foot (3.0 meters) radius without any abrupt height differences. The substrate should not slope more than 1 inch (25.0mm) per 6 feet (1.8 meters) in any direction. Fill in grout lines on ceramic tiles, terrazzo, quarry tiles and similar floors with cementitious leveling and patching compound.

NON-APPROVED SUBSTRATES

Remove the floors noted below and remove old adhesive before installing Aspecta TEN. Encapsulate adhesive and cutback residue.

- Carpeting/Carpet Pad
- Cushion Back Sheet Vinyl
- Engineered Hardwood Over Concrete
- Floating Floors
- Hardwood Over Concrete
- Parquet Over Concrete
- Sleeper Substrates

NOTE: Various Federal, State and Local government agencies have established regulations governing the removal of in-place asbestos-containing material. If you contemplate the removal of a resilient floor covering structure that contains (or is presumed to contain) asbestos, you must review and comply with all applicable regulations. Do not sand, dry sweep, dry scrape, drill, saw, bead blast, or mechanically chip or pulverize existing resilient flooring, backing, lining felt, asphalt "cut-back" adhesive, or other adhesive. These products may contain asbestos fibers and/or crystalline silica. Avoid creating dust. Inhalation of such dust is a cancer and respiratory tract hazard. Smoking by individuals exposed to asbestos fibers greatly increases the risk of bodily harm. Unless positively certain that the product is a non-asbestos containing material, you must presume it contains asbestos. Regulations may require that the material be tested to determine asbestos content. The RFCI's Recommended Work Practices for Removal of Resilient Floor Covering are a defined set of instructions addressed to the task of removing all resilient floor covering structures. For further information, visit the Resilient Floor Covering Institute website at www.rfci.com

PREPARE THE JOB SITE

Careful preparation is the key to outstanding results. All Trades Must Finish Before Installing Aspecta TEN.

- **Install Permanent Exterior Doors and Windows**
- **Turn on HVAC at Least One Week Prior to Installation** - Room temperature should be maintained between 50°F - 100°F (10°C - 38°C) at least 48 hours prior to installation.
- **Allow all other Trades to Finish**

- **Perform Recommended Moisture and pH Tests** - See the "Identify Your Substrate" section of this manual (pages 3-4) for further information about suggested tests.
- **Level Uneven Substrates** - All subfloors must meet all minimum standard building codes. Fill large cracks and voids with cementitious leveling and patching compound. In order to prevent vertical deflection (movement) and potential damage to the integrity of the Aspecta TEN flooring, all substrates must be sturdy, sound, and flat within $\frac{3}{16}$ of an inch (5.0mm) within a 10-foot (3.0 meters) radius without any abrupt height differences. The substrate should not slope more than 1 inch (25.0mm) per 6 feet (1.8 meters) in any direction.
- **Remove Wall Base Moldings** - Remove wall base moldings prior to installation. Leave appropriate expansion space between the edge of the flooring and walls or vertical surfaces.
- **Fill Grout Lines** - Fill grout joints when installing over existing ceramic tile or stone floors to obtain a smooth surface. Follow Subfloor Flatness Tolerances per chart on page 6.
- **Remove Non-approved Substrates**
- **Remove or Encapsulate Old Adhesive** - Old adhesives must be scraped up and left so that no ridges or puddles are evident and all that remains is a thin, smooth film. Then, encapsulate residue.
- **Undercut Wood Door Casings** - Wood door casings should be undercut so that Aspecta TEN will fit neatly beneath them, concealing the expansion space.
- **Cut Around Metal Door Casings** - Do not cut metal door casings. Cut Aspecta TEN around them, leaving the appropriate expansion space. After installation, fill the space with a coordinating premium waterproof 100% silicone caulk.
- **Clean Up the Job Site** - Remove all debris, sweep and vacuum the subfloor. Smooth, non-porous floors should be damp-mopped after vacuuming and allowed to dry thoroughly before installing Aspecta TEN. All dust must be removed prior to installation.

CHECK RUN NUMBERS AND MANUFACTURE DATE

Locate the run number on the short end of each carton and verify that all of the material for your job is from the same run. Minor shade variations within the same run number contribute to the natural look of Aspecta TEN. To avoid noticeable shade variations, do not install material from different runs across large expanses.

To determine manufacture date, locate the run number on the short end of the carton. It is the eight-digit number separated by decimal points. Examples:

Run Number/Manufacture Date
29.10.2013
DAY.MONTH.YEAR

Run Number/Manufacture Date
2013.29.10
YEAR.DAY.MONTH



KEY INSTALLATION CONSIDERATIONS

Subfloor Flatness Tolerances	$\frac{3}{16}$ " (5.0mm) in 10' (3.0 meters) without any abrupt height differences Slope no more than 1" (25.0mm) in 6' (1.8 meters)
Vapor Barrier (6 mil polyfilm)	Not Required
Is underlayment (pad) required	No – Aspecta TEN includes an integral pre-attached pad
Acclimation Requirements	48 hours*
Transition Requirements (T-Mold) for Large Spaces	Required in rooms greater than 100' (30.5 meters) in either direction
Transition Requirements (T-Mold) Doorways/Thresholds	Required
Installation over existing ceramic tile floor	Filling grout lines required, follow Subfloor Flatness Tolerances
Glue Down Installation	Not Required/Not Recommended
Subfloor RH/MVER Recommendations	85% RH/8 lbs MVER
Radiant Heat	Approved – Substrate surface temp. not to exceed 85°F (29°C)
3-Season/Non-Climate Controlled Environments	Not Recommended
Perimeter Expansion Requirements	$\frac{3}{8}$ " (9.5mm) around perimeter walls, pipes, & heavy fixed objects such as cabinetry**
Optimal Interior Environmental Conditions	50°F - 100°F (10°C - 38°C) / 40% – 60% RH
Definition of "Waterproof"	Structural integrity of flooring will not degrade due to contact with moisture/water***

*While Aspecta TEN flooring is more dimensionally stable than typical floating wood or vinyl based flooring products, acclimation is still required. Aspecta TEN flooring subjected to extreme hot or cold conditions can cause the material to become too flexible or rigid, making the material difficult to install and potentially causing damage to the locking system. Optimum material and building temperature range for installation is 50°F - 100°F (10°C - 38°C).

**If installing Aspecta TEN in an environment that has a length greater than 100' (30.5 meters), a T-Molding should be utilized to separate the floor into two (2) separate sections.

***Although Aspecta TEN is waterproof, it is not intended for use as a moisture mitigation system.

WARNING: Only installation techniques described in this installation guide are warranted. Aspecta does not warrant Aspecta TEN installations involving custom cutting, such as 45-degree mitered corners and serpentine edges. Please refer to the Aspecta TEN warranty for complete warranty details and exclusions.



ASPECTA™ TEN

Featuring **ISOCORE** Technology™

INSTALLATION FOR ASPECTA TEN WITH DROPLock100 PROFILE



Installation will move from left to right beginning in the left corner with tongue side of long edge facing the wall.



SET SPACERS

Create the required expansion space between the perimeter planks and the wall using spacers. Place spacers equaling the thickness for required expansion between plank and wall on short and long ends of plank. Do not remove them until the installation is complete.



INSTALL FIRST PLANK

Position the first plank against a spacer a few inches from the starting wall.

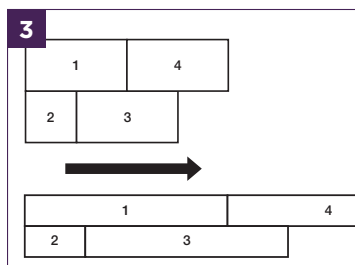

ESTABLISH PROPER STAGGERING

Maintain a minimum 6-inch (152mm) end-joint stagger from row-to-row throughout the entire installation. Tile products should be staggered in a bricklaid pattern with stagger equal to $\frac{1}{2}$ of a tile. Installation alternates back and forth between rows one and two, for the first two rows only.



FIRST PLANK SECOND ROW

Cut the first plank in the second row to one-third its length before installing it. Insert the long tongue edge of the plank into the long groove edge of the first plank. Make sure there are no gaps. Tap along the long groove edge using the Prevail™ Tapping Block.



SECOND PLANK SECOND ROW

Insert the long side then slide the plank until the short tongue touches the short groove edge on the first plank of the second row. Press the joint into place with your fingers and tap the short joint with a lightweight Dead Blow Hammer (see photo 6). Square the joint by tapping the long edge of the plank using the Prevail Tapping Block, if necessary.



SECOND PLANK FIRST ROW

Select a full plank and position the long groove edge into the tongue of the second plank in the second row. Press, tap and square as before. Repeat the same installation pattern until you reach the opposite wall and cannot install another full plank.

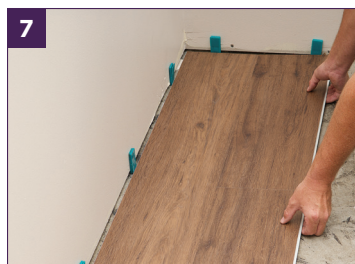

INSTALL THE LAST PIECES OF ROWS 1 AND 2

Cut to fit, maintaining the expansion gap. Install as before. Move the entire assembly against the spacers on the starting wall.



INSTALL REMAINING ROWS

Install the remaining material, one row after the other. Always press, tap (if necessary) and square as you go, and maintain the required stagger throughout the install.

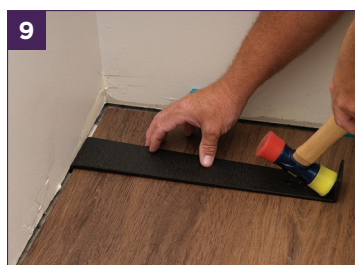

INSTALL THE LAST ROW

Cut the final row of planks to fit along the wall. Use a pull bar to lock the long edges together. Do not use the pull bar on the short edges.

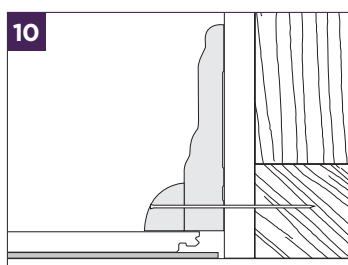

FINISH THE JOB

Remove spacers. Cover expansion space with quarter round or other trim, being sure not to trap or pin down the floor.



ASPECTA
TEN
Featuring  **ISO CORE** Technology™

GENERAL CARE & MAINTENANCE

ROUTINE CARE & MAINTENANCE

- Sweep, dust mop or vacuum daily. Do not use vacuums with any type of beater bar assembly.
- Lightly damp mop with Prevail™ Neutral Cleaner. Remove excess soil by carefully scrubbing with a soft nylon brush or magic eraser sponge and Prevail Neutral Cleaner.
- Remove scuffs using Prevail Neutral Cleaner and a soft nylon brush or magic eraser sponge.
- Heavily soiled floors may require an occasional deep cleaning using Prevail Neutral Cleaner, spray bottle and a low-speed buffer not exceeding 300 RPM. Fit the buffer with a red or white scrubbing pad, spray the cleaner solution onto a manageable area of the floor and scrub. Remove the dirty residue by damp mopping with clear water. **Caution:** Do not flood the floor.
- Remove standing water, pet urine and other liquids promptly. Follow with Prevail 1-Step Neutral Cleaner or Prevail Ready to Use Neutral Cleaner.

PREVENTIVE CARE

- Use non-staining walk-off mats at all outside entrances.
- Use flat glides at least 2" (50mm) in diameter under furniture legs or free standing displays and fixtures to prevent indentations and scratches.
- Use broad surface non-staining casters at least 2" (50mm) in diameter on rolling fixtures or furniture.
- Do not use vinegar, polishes, waxes, oil soaps, abrasive cleaners, harsh detergents, "mop and shine" products or solvents.
- Do not expose to direct sunlight for prolonged periods.
- Do not use steam cleaners.
- Do not flood floor or subject to standing liquids, including pet urine.



ASPECTA
A NEW DIMENSION IN FLOORING

For further information, inquiries and troubleshooting please contact:
Aspecta Customer Service Monday to Friday, 8:00 a.m. to 5:00 p.m. CST at **(855) 400-7732**
or visit our website at **www.aspecta flooring.com**.